

Back-to-Back Flat Screen Ceiling / Desk Mount with Tilt and Swivel



BT7554

Back-to-Back Flat Screen Ceiling Desk / Mount with Tilt and Swivel

Designed to mount 2 screens in a Back-to-Back configuration from the ceiling or a desktop

- Suitable for screens using VESA® fixings 75 x 75mm and 100 x 100mm
- Maximum load: 23kg (51lbs) per screen
- +/- 10° tilt adjustment and 360° swivel
- 360° screen rotation
- Allows screen to be positioned at almost any angle
- Integrated cable management
- Keyhole mounting for easy 'hook-on' installation
- Screens can be mounted offset from, or in-line with each other using the optional adaptor arms (included)
- Coverplate included for a smart installation
- Integrated cable management
- Available in five lengths:
BT7554-025: 25cm pole
BT7554-050: 50cm pole
BT7554-100: 1m pole
BT7554-150: 1.5m pole
BT7554-200: 2m pole
- Available in Black with the choice of Black or Chrome poles



Per Screen



Can be mounted to the ceiling, floor or desktop

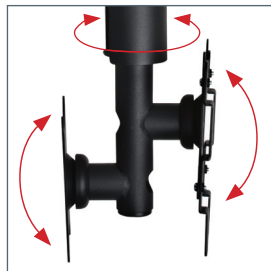

Easy tilt adjustment +/-10°, 360° swivel and 360° screen rotation



Mount screens offset from each other or in-line using the optional adaptor arms (included)



Integrated cable management

Back-to-Back Flat Screen Ceiling / Desk Mount with Tilt and Swivel

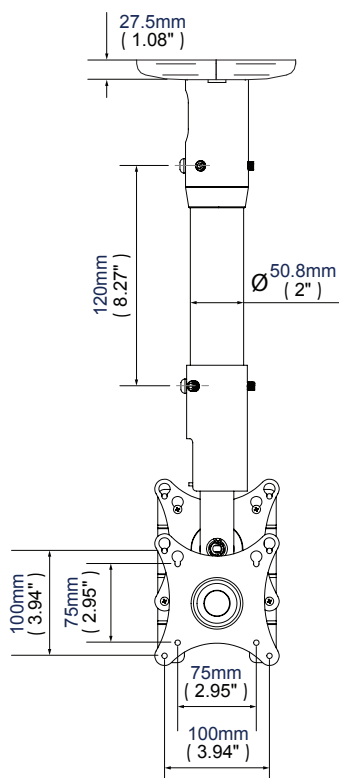

BT7554-025 Front View

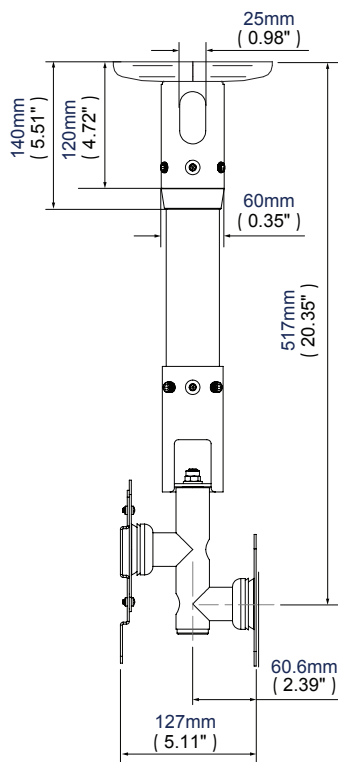

BT7554-025 Side View

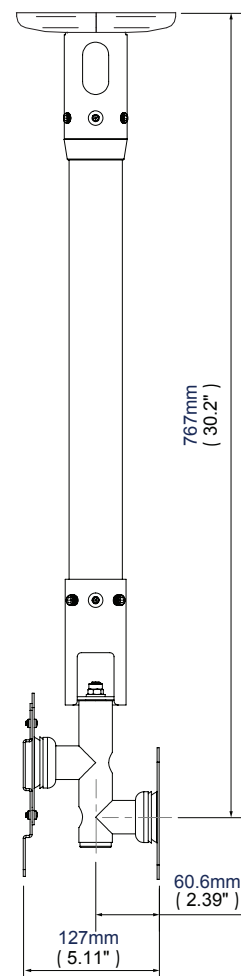

BT7554-050 Side View

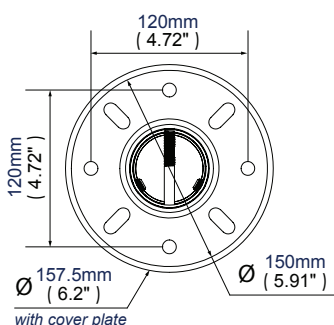

Ceiling Plate

Product Code / Order Ref:	Colour:	EAN Code:
BT7554-025/BB	Black with Black Poles	5019318759185
BT7554-025/BC	Black with Chrome Poles	5019318759192
BT7554-050/BB	Black with Black Poles	5019318759208
BT7554-050/BC	Black with Chrome Poles	5019318759215
BT7554-100/BB	Black with Black Poles	5019318759536
BT7554-100/BC	Black with Chrome Poles	5019318759543
BT7554-150/BB	Black with Black Poles	5019318759550
BT7554-150/BC	Black with Chrome Poles	5019318759567
BT7554-200/BB	Black with Black Poles	5019318759574
BT7554-200/BC	Black with Chrome Poles	5019318759581

**This information is intended as a guide only and reflects the current specification at the time of print.
B-Tech accepts no liability for the accuracy of the information contained in this document.**